

THIS DOCUMENT IS SUBJECT TO CHANGE WITHOUT NOTICE. IT IS CONFIDENTIAL AND A PROPERTY OF Amphenol LTW. DISCLOSURE TO THIRD PARTY HAS TO BE AUTHORIZED BY Amphenol LTW.

REV.	ECN NO.	DATE	SIGN	DESCRIPTION
B	LEN-870139	2008/07/25	Yuri	Update Drawing
C	LEN1741290	2017/04/18	Vicky	Update Logo

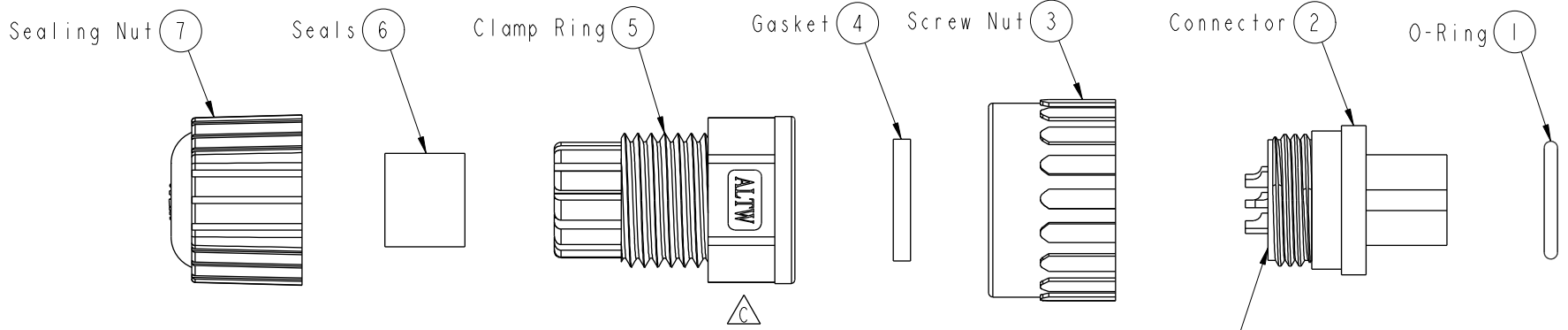

With Liquid Glue

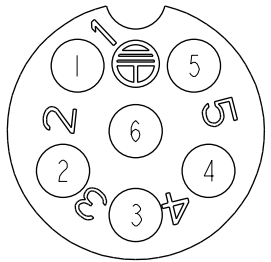
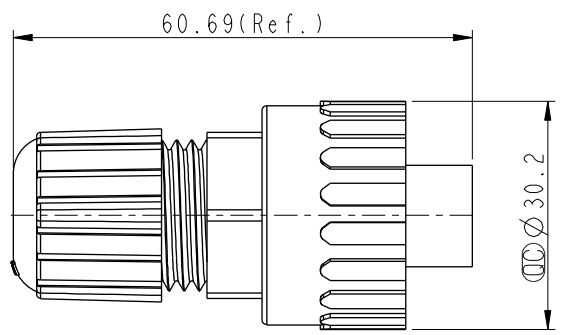

Pin Assignments  
Front View

- Note:
- \*  $\varnothing$  Important Dimension
  - \* Waterproof Rate: IP67
  - \* Seals for Cable OD:  $\varnothing 5.5\text{mm} \sim \varnothing 10.8\text{mm}$   
(防水墊圈限用線徑:  $\varnothing 5.5\text{mm} \sim \varnothing 10.8\text{mm}$ )
  - \* One Set Unassembled in One LTW Sealed Bag  
(每一組未組裝, 放置於一個 Amphenol LTW 封口袋)
  - \* Housing: Nylon+GF, Black
  - \* Female Pin: Copper Alloy, Gold Plated
  - $\triangle$  \* O-Ring: EPDM, Black
  - \* Screw Nut: Nylon+GF, Black
  - $\triangle$  \* Gasket: Silicone, Black
  - \* Clamp Ring: Nylon, Black
  - \* Seals: EPDM, Black
  - \* Sealing Nut: Nylon, Black
  - \* Liquid Glue: Claer

UNIT:mm		
TOLERANCE	.X $\pm 0.25$	
	.XX $\pm 0.1$	
	.XXX $\pm 0.05$	
ANGLES	$\pm 1^\circ$	

TITLE Power, Assy Screw 6Pin F Conn F Pin			
SCALE 1:1	SIZE A4	SHEET 1 OF 1	
REV. C	WC-REV. A.5	$\varnothing$ : Inspection item	

**Amphenol LTW**  
安費諾亮泰企業股份有限公司

ITEM NO PWE-06BFFA-SL7001	DRAWN BY Vicky	DATE 2017-04-18
DWG NO PWE-06BFFA-SL7001	CHECKED BY Rita	DATE 2017-04-18
CUSTOMER ALTW	APPROVED BY Max	DATE 2017-04-18