

THIS DOCUMENT IS SUBJECT TO CHANGE WITHOUT NOTICE. IT IS CONFIDENTIAL AND A PROPERTY OF Amphenol LTW. DISCLOSURE TO THIRD PARTY HAS TO BE AUTHORIZED BY Amphenol LTW.

REV.	ECN NO.	DATE	SIGN	DESCRIPTION
A		2021/03/03	Carl Dong	Rev.01 to Rev.A

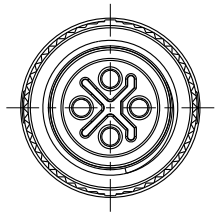

CI

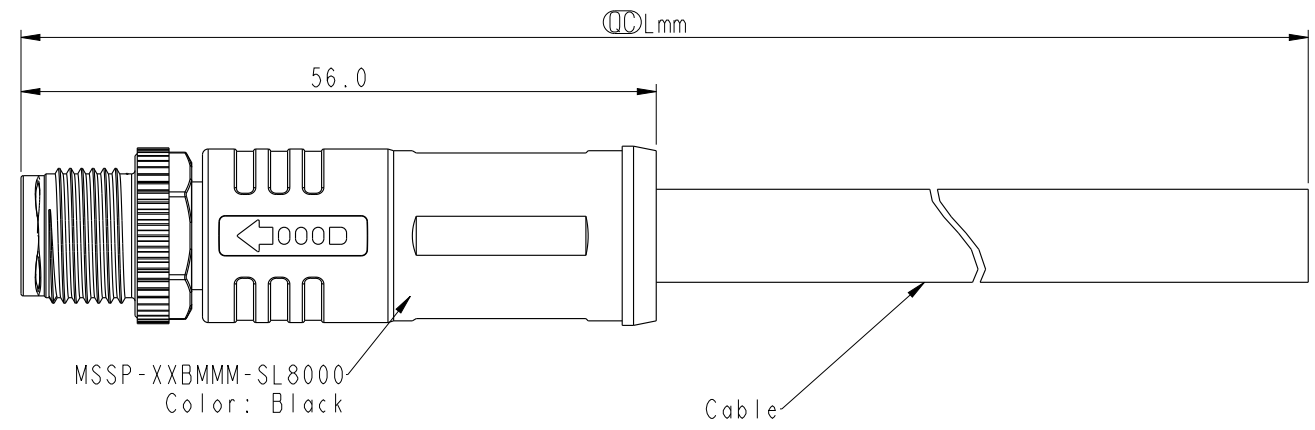

MSSP-XXBMMM-SL8000  
Color: Black

Cable

PE Yellow/Green 黃/綠	PE Yellow/Green 黃/綠
3 Blue 藍	3 Blue 藍
2 White 白	2 --
1 Brown 棕	1 Brown 棕
Pin#	Wire

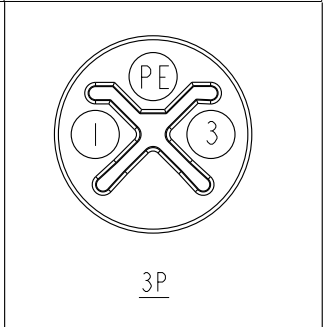
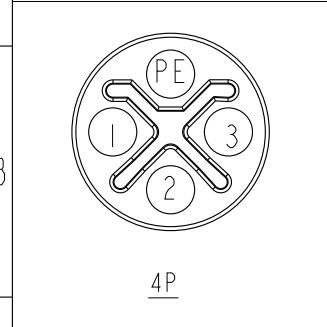

Pin Assignments Front View

MSSP-XXBMMM-SL8SXX  
 XX: 01~99Meters  
 01: 01Meter  
 :  
 99: 99Meters  
 XX: Number of Pin

- Note:
- \* RoHS Compliant
  - \*  $\varnothing$  Important Dimension to Check
  - \* Waterproof Rate: IPX8, Mated 1m/24h
  - \* Connector:
    - Housing: Thermoplastic, Black
    - Pin: Copper Alloy, Gold Plated
    - Nut: Thermoplastic, Black
    - Outer Mold: Thermoplastic, Black
  - \* Cable: UL20234, 16AWG, PU Jacket, Black
  - \* Cable Length Tolerance: 01M: +50/-0mm

1M < L ≤ 3M: +100/-0 mm
3M < L ≤ 5M: +150/-0 mm
5M < L ≤ 10M: ±100 mm
10M < L ≤ 20M: ±200 mm
20M < L ≤ 30M: ±300 mm
30M < L ≤ 99M: ±500 mm

UNIT:mm		TITLE
TOLERANCE	$\pm 0.5mm$	M12 S-CODE, STRAIGHT, MALE CONN +CABLE
SCALE	3:2	SIZE
REV.	A	WC-REV.
		.0
		$\varnothing$ : Inspection item

**Amphenol LTW**  
安費諾亮泰企業股份有限公司

ITEM NO	MSSP-XXBMMM-SL8SXX	DRAWN BY	Carl Dong	DATE	2021/03/03
DWG NO	MSSP-XXBMMM-SL8SXX	CHECKED BY	Fisher Wang	DATE	2021/03/03
CUSTOMER	ALTW	APPROVED BY	Max Yang	DATE	2021/03/03