

REV.	ECN NO.	DATE	SIGN	DESCRIPTION
D	LEN1350138	2013/05/08	Lu Di	Change Logo
E	LE31730083	2017/03/03	Ruru	Change Outer Mold Design
F	C202041	2020/12/25	Vicky	△F*1

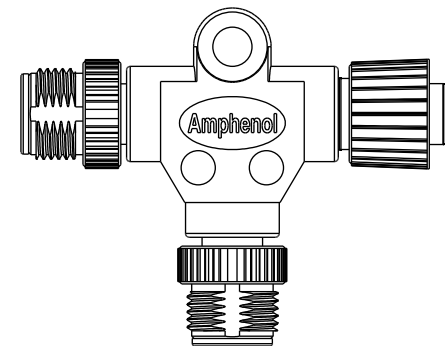

Back View

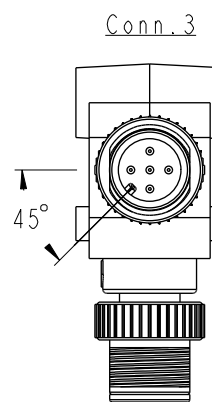
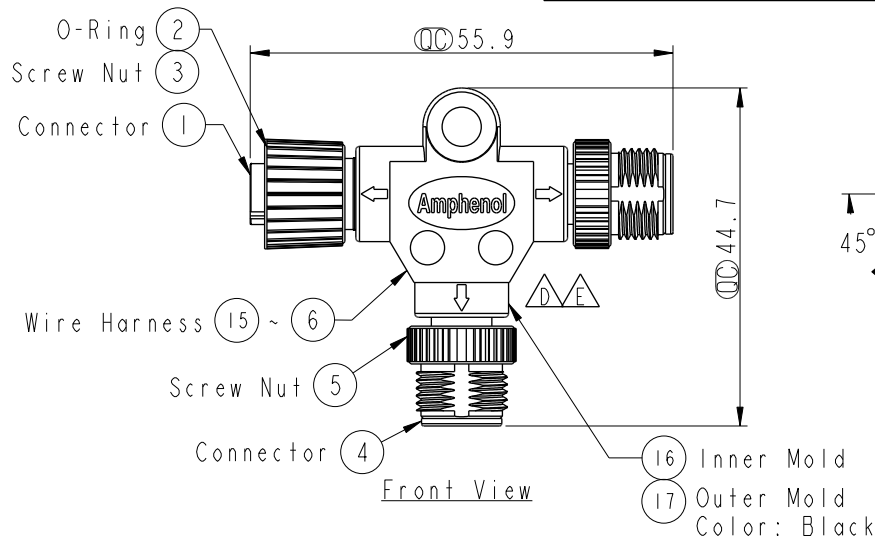
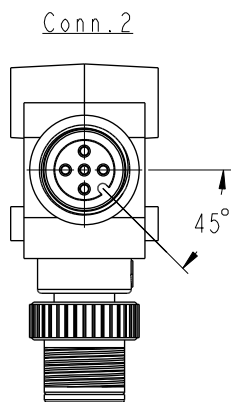
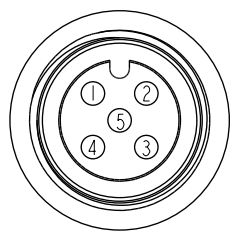

Conn. 2  
Pin Assignments  
Front View

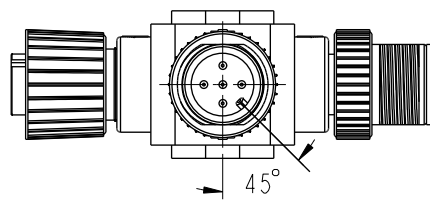

Conn. 1

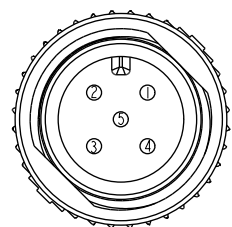

Conn. 1&3  
Pin Assignments  
Front View

Blue (24AWG) 藍	5	5	5
White (24AWG) 白	4	4	4
Black (22AWG) 黑	3	3	3
Red (22AWG) 紅	2	2	2
Green (24AWG) 綠	1	1	1
Wire Color	Conn. 1	Conn. 2	Conn. 3

△C Pin Out

Note:

- \* (M) Important Dimension
- \* Waterproof Rate: IP68  
In 1 meter water within 24 hours
- \* Connector: PU, Black
- \* O- Ring: Viton, Green
- \* △F \* Screw Nut: Zinc Alloy, Nickel Plated
- \* △C \* Pin: Copper Alloy, Gold Plated
- \* △C \* Wire Harness: UL1061 24AWG, Green, White, Blue
- \* △C \* Wire Harness: UL1061 22AWG, Red, Black

UNIT:mm	
TOLERANCE	± 0.5mm △B

TITLE M12 Conn T Adaptor △B △C MFM Conn MFM Pin, 5Pin			
SCALE 1:1	SIZE A4	SHEET 1 OF 1	
REV. F	WC-REV. A.1	◎◎: Inspection item	

**Amphenol LTW**  
安費諾亮泰企業股份有限公司

ITEM NO SS-050505-MFM-TS00 △B	DRAWN BY Ruru	DATE 2017-03-03
DWG NO SS-050505-MFM-TS00 △B	CHECKED BY Rita	DATE 2017-03-03
CUSTOMER ALTW	APPROVED BY Max	DATE 2017-03-03

THIS DOCUMENT IS SUBJECT TO CHANGE WITHOUT NOTICE. IT IS CONFIDENTIAL AND A PROPERTY OF Amphenol LTW. DISCLOSURE TO THIRD PARTY HAS TO BE AUTHORIZED BY Amphenol LTW.